

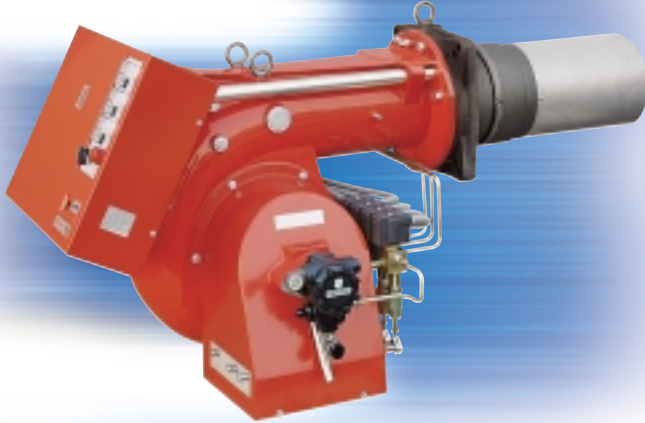

THREE STAGE LIGHT OIL BURNERS

► PRESS T/G SERIES

► P 140 T/G	380/830 ÷ 1660 kW
► P 200 T/G	557/1186 ÷ 2372 kW
► P 300 T/G	712/1779 ÷ 3560 kW
► P 450 T/G	890/2670 ÷ 5340 kW



The PRESS T/G series of burners cover a firing range from 380 to 5340 kW.

Available in 4 different models, they are particularly well suited for matching with pressurized chamber boilers.

For their characteristics, they find application in big civil plants for domestic heating or in industrial applications where thermal load is repetitive and predictable.

An hydraulic ram exclusive system, with 3 adjustable positions, regulates dampers opening, allowing air passage in relation to output required: in this way flame stability is optimized in every working point, with micro-regulation available.

The burners are fitted with a microprocessor control panel which supplies indication of operation and diagnosis of fault cause.

FIRING RATES

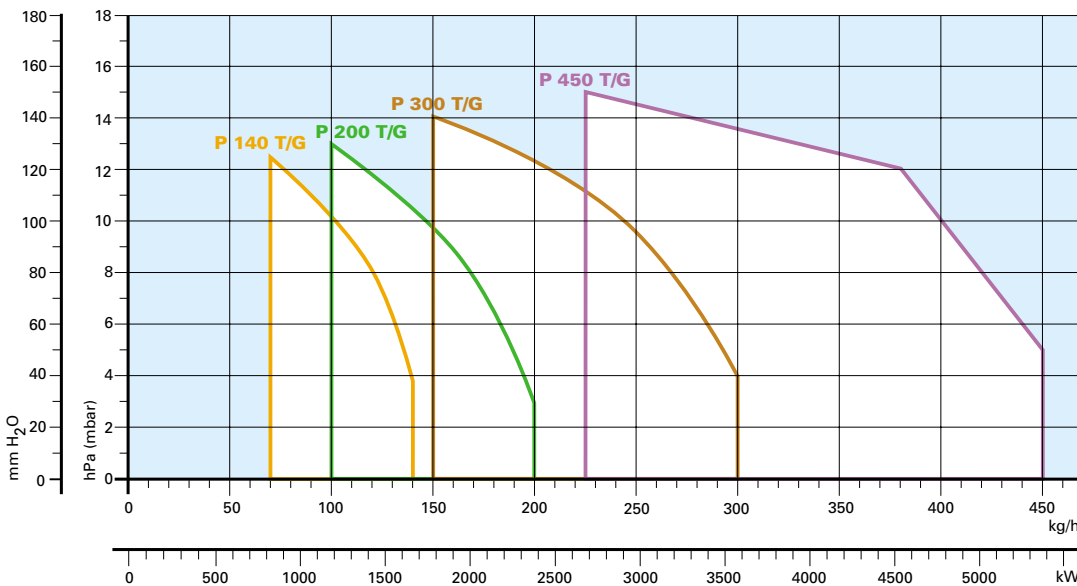

□ Useful working field for choosing the burner

Test conditions conforming to EN 267:
 Temperature: 20°C
 Pressure: 1000 mbar
 Altitude: 100 m a.s.l.

T/G series - OVERALL DIMENSIONS (mm)

BURNER

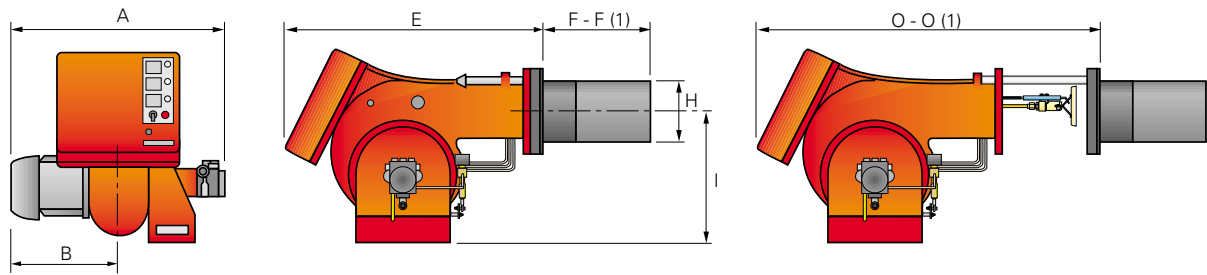

Model	A	B	E	F - F (1)	H	I	O - O (1)
▶ P 140 T/G	765	365	890	363 - 473	222	467	1250 - 1360
▶ P 200 T/G	796	396	890	391 - 501	250	467	1280 - 1390
▶ P 300 T/G	858	447	1000	444 - 574	295	496	1440 - 1570
▶ P 450 T/G	950	508	1070	476 - 606	336	525	1546 - 1676

(1) Length with extended combustion head.

BURNER - BOILER MOUNTING FLANGE

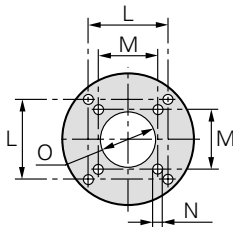

Model	L	M	N	O
▶ P 140 T/G	260	230	M14	225
▶ P 200 T/G	260	-	M16	255
▶ P 300 T/G	260	-	M18	300
▶ P 450 T/G	310	-	M20	340

PACKAGING

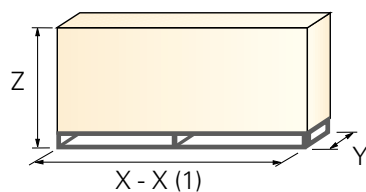

Model	X - X (1)	Y	Z	kg
▶ P 140 T/G	1500	930	905	130
▶ P 200 T/G	1500	930	905	220
▶ P 300 T/G	1780	1085	990	238
▶ P 450 T/G	1780	1085	990	300

(1) Length with extended combustion head.

T/G series - SPECIFICATION

DESIGNATION OF SERIES

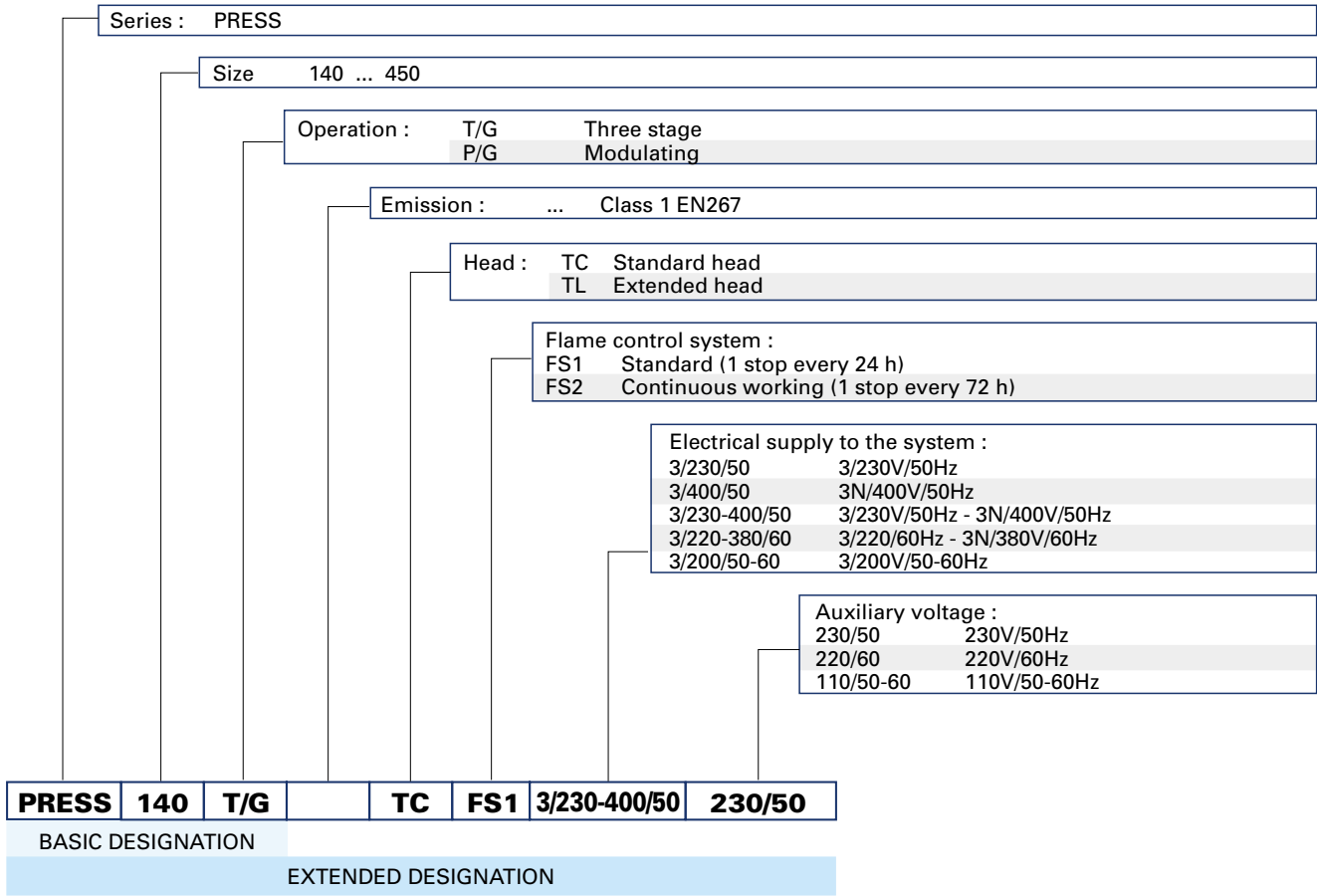

T/G series - STATE OF SUPPLY

Monoblock forced draught oil burner with three stage operation, fully automatic, made up of:

- Air suction circuit lined with sound-proofing material
- Fan with forward curved blades high performance pressure levels
- Air dampers for air setting controlled by a three stage hydraulic ram
- Starting motor at 2850 rpm, three-phase 400 V with neutral, 50 Hz
- Combustion head, that can be set on the basis of the combustion output, fitted with:
 - stainless steel end cone, resistant to corrosion and high temperatures
 - ignition electrodes
 - flame stability disk
- Gears pump for high pressure fuel supply, fitted with:
 - filter
 - pressure regulator
 - connections for installing a pressure gauge and vacuumeter
 - internal by-pass for single pipe installation
- Valve unit with a oil safety valve and three oil delivery valves on the output circuit;
- Photocell for flame detection
- Microprocessor based flame control panel, with diagnostic function
- Burner on/off switch
- Flame inspection window
- Slide bars for easier installation and maintenance
- Protection filter against radio interference
- IP 40 electric protection level.

Standard equipment:

- 2 flexible pipes for connection to the oil supply network
- 2 nipples for the connection to the pump
- 4 wiring looms fittings for electrical connections
- 4 screws for fixing the burner flange to the boiler
- Instruction handbook for installation, use and maintenance
- Spare parts catalogue
- 2 slide bar extensions (for the extended model of P 300 T/G and P 450 T/G)
- 3 nozzles
- Gasket for flange
- Starter (for versions with star-delta starting)
- Diffuser disk (P 450 T/G).

T/G series - AVAILABLE BURNER MODELS

Code	Model	Heat output		Total electrical power kW	Certification	Note	Price
		kW	kg/h				
3476823	PRESS 140 T/G TC FS1 3/230-400/50 230/50	380/830+1660	32/70+140	4,5	DIN 5G455/2000		
3476824	PRESS 140 T/G TL FS1 3/230-400/50 230/50	380/830+1660	32/70+140	4,5	DIN 5G455/2000		
3476885	PRESS 140 T/G TC FS1 3/220-380/60 220/60	380/830+1660	32/70+140	4,5	-		
3476886	PRESS 140 T/G TL FS1 3/220-380/60 220/60	380/830+1660	32/70+140	4,5	-		
3477723	PRESS 200 T/G TC FS1 3/230-400/50 230/50	557/1186+2372	47/100+200	5,5	DIN 5G456/2000		
3477724	PRESS 200 T/G TL FS1 3/230-400/50 230/50	557/1186+2372	47/100+200	5,5	DIN 5G456/2000		
3477785	PRESS 200 T/G TC FS1 3/220-380/60 220/60	557/1186+2372	47/100+200	5,5	-		
3477786	PRESS 200 T/G TL FS1 3/220-380/60 220/60	557/1186+2372	47/100+200	5,5	-		
3478837	PRESS 300 T/G TC FS1 3/230-400/50 230/50	712/1779+3560	60/150+300	10	DIN 5G457/2000		
3478838	PRESS 300 T/G TL FS1 3/230-400/50 230/50	712/1779+3560	60/150+300	10	DIN 5G457/2000		
3478839	PRESS 300 T/G TC FS1 3/230/50 230/50	712/1779+3560	60/150+300	10	DIN 5G457/2000		
3478840	PRESS 300 T/G TL FS1 3/230/50 230/50	712/1779+3560	60/150+300	10	DIN 5G457/2000		
3478841	PRESS 300 T/G TC FS1 3/400/50 230/50	712/1779+3560	60/150+300	10	DIN 5G457/2000		
3478842	PRESS 300 T/G TL FS1 3/400/50 230/50	712/1779+3560	60/150+300	10	DIN 5G457/2000		
3478985	PRESS 300 T/G TC FS1 3/220-380/60 220/60	712/1779+3560	60/150+300	10	-		
3478986	PRESS 300 T/G TL FS1 3/220-380/60 220/60	712/1779+3560	60/150+300	10	-		
3479336	PRESS 450 T/G TC FS1 3/230/50 230/50	890/2670+5340	75/225+450	15	-		
3479337	PRESS 450 T/G TL FS1 3/230/50 230/50	890/2670+5340	75/225+450	15	-		
3479338	PRESS 450 T/G TC FS1 3/400/50 230/50	890/2670+5340	75/225+450	15	-		
3479339	PRESS 450 T/G TL FS1 3/400/50 230/50	890/2670+5340	75/225+450	15	-		

Net calorific value: 11,8 kWh/kg - 10200 kcal/kg - Viscosity at 20°C: 4+6 mm²/s (cSt)

The burners of PRESS series are in according to 89/336 - 73/23 - 92/42 - 89/392 CEE Directive and EN 267 Norm.

T/G series - BURNER ACCESSORIES

Nozzles type 60° B



The following list shows the features and codes on the basis of the maximum required fuel output.

NOTE: each burner needs N° 3 nozzles.

Burner	Rated delivery (kg/h) at 12 bar	GPH	Nozzle code	Price
P 140 T/G	13,57	3,5	3042162	
P 140 T/G	15,51	4	3042172	
P 140 T/G	17,45	4,5	3042182	
P 140 T/G - P 200 T/G	19,39	5	3042192	
P 140 T/G - P 200 T/G	23,27	6	3042212	
P 140 T/G - P 200 T/G	25,21	6,5	3042222	
P 140 T/G - P 200 T/G	27,14	7	3042232	
P 140 T/G - P 200 T/G	29,08	7,5	3042242	
P 140 T/G - P 200 T/G	31,02	8	3042252	
P 140 T/G - P 200 T/G	32,96	8,5	3042262	
P 140 T/G - P 200 T/G	34,9	9	3042586	
P 140 T/G - P 200 T/G	36,84	9,5	3042282	
P 140 T/G - P 200 T/G	38,78	10	3042292	
P 140 T/G - P 200 T/G	42,66	11	3042312	
P 200 T/G	46,53	12	3042322	
P 200 T/G	50,41	13	3042332	
P 200 T/G - P 300 T/G	54,29	14	3042352	
P 200 T/G - P 300 T/G	58,17	15	3042362	
P 300 T/G	62,05	16	3042382	
P 300 T/G	65,92	17	3042392	
P 300 T/G - P 450 T/G	69,8	18	3042412	
P 300 T/G - P 450 T/G	73,68	19	3042422	
P 300 T/G - P 450 T/G	77,56	20	3042442	
P 300 T/G - P 450 T/G	85,31	22	3042462	
P 300 T/G - P 450 T/G	93,07	24	3042472	
P 450 T/G	100,82	26	3042482	
P 450 T/G	108,58	28	3042492	
P 450 T/G	116,33	30	3042502	
P 450 T/G	124,09	32	3042512	
P 450 T/G	135,72	35	3042522	

Spacer kit

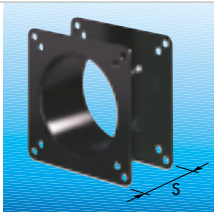

If burner head penetration into the combustion chamber needs reducing, varying thickness spacers are available, as given in the following list:

Burner	Spacer thickness S (mm)	Kit code	Price
P 140 T/G	110	3000722	
P 200 T/G	110	3000722	
P 300 T/G	130	3000723	
P 450 T/G	130	3000751	

Sound proofing box



Burner	Box type	Average noise reduction [dB(A)]	Box code	Price
P 140 T/G - P 200 T/G	C5	15	3000780	
P 300 T/G - P 450 T/G	C6	16	3000781	

If noise emission needs reducing even further, sound-proofing boxes are available.

Burner support

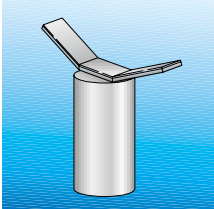

Burner	Support code	Price
P 300 T/G - P 450 T/G	3000731	

For easier maintenance, a mobile burner support has been designed, which means the burner can be dismantled without the need of forklift trucks.

Interface adapter kit



Burner	Kit code	Price
P 140 T/G - P 200 T/G - P 300 T/G - P 450 T/G	in progress	

To connect the flame control panel to a personal computer for the transmission of operation, fault signals and detailed service information, an interface adapter with PC software are available.