

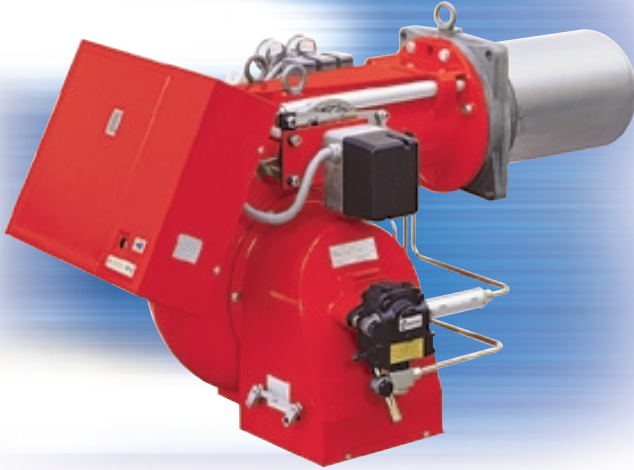

## MODULATING LIGHT OIL BURNERS

### ► PRESS P/G SERIES

► P 140 P/G	415/830 ÷ 1660 kW
► P 200 P/G	590/1185 ÷ 2370 kW
► P 300 P/G	890/1780 ÷ 3560 kW
► P 450 P/G	1190/2670 ÷ 5340 kW



The PRESS P/G series of burners cover a firing range from 415 to 5340 kW.

Operation can be "two stage progressive" or, alternatively, "modulating" with the installation of a PID logic regulator and respective probes, which guarantees a turn down ratio of 3:1.

The versatility of this range makes the burner well suited for use on commercial or industrial applications where the load factor is subject to wide variations over a short period of time.

Simplified maintenance is achieved by the Riello designed slide bar system, which allows easy access to all of the essential components of the combustion head.

### FIRING RATES

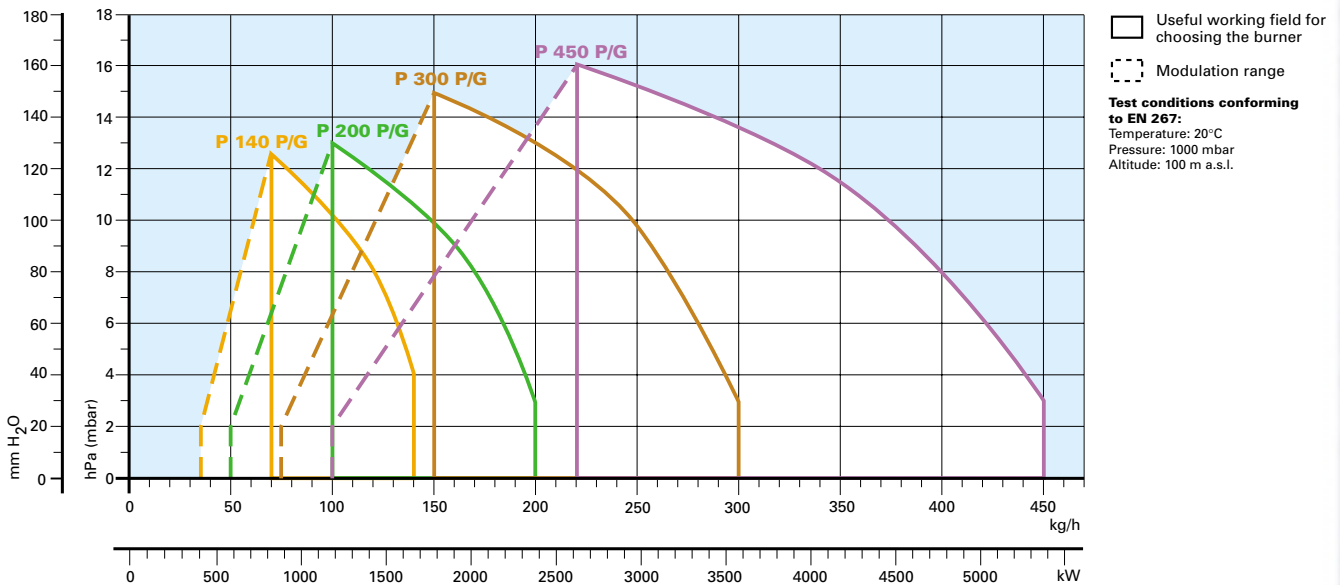

## P/G series - OVERALL DIMENSIONS (mm)

### BURNER

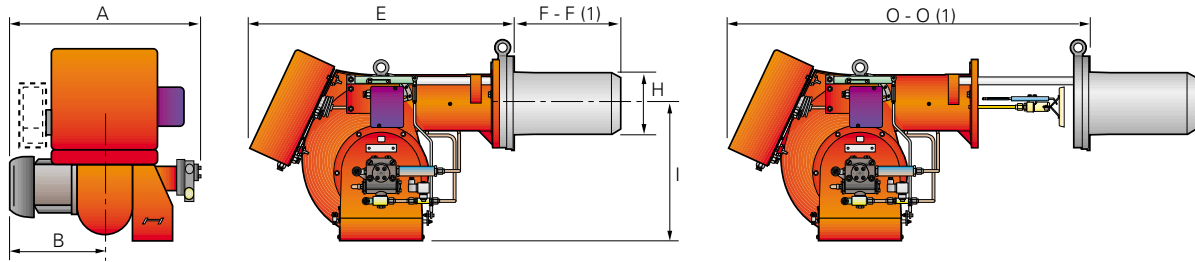

Model	A	B	E	F - F (1)	H	I	O - O (1)
▶ P 140 P/G	765	365	890	363 - 473	222	467	1250 - 1360
▶ P 200 P/G	796	396	890	391 - 501	250	467	1280 - 1390
▶ P 300 P/G	858	447	1000	444 - 574	295	496	1440 - 1570
▶ P 450 P/G	950	508	1070	476 - 606	336	525	1546 - 1676

(1) Length with extended combustion head.

### BURNER - BOILER MOUNTING FLANGE

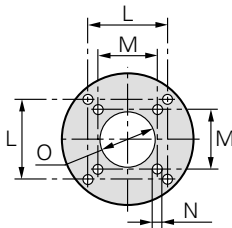

Model	L	M	N	O
▶ P 140 P/G	260	230	M14	225
▶ P 200 P/G	260	-	M16	255
▶ P 300 P/G	260	-	M18	300
▶ P 450 P/G	310	-	M20	340

### PACKAGING

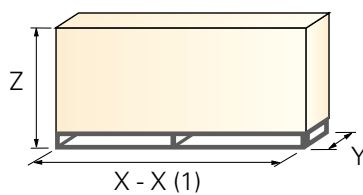

Model	X - X (1)	Y	Z	kg
▶ P 140 P/G	1500	930	905	130
▶ P 200 P/G	1500	930	905	220
▶ P 300 P/G	1780	1085	990	238
▶ P 450 P/G	1780	1085	990	300

(1) Length with extended combustion head.

# P/G series - SPECIFICATION

## DESIGNATION OF SERIES

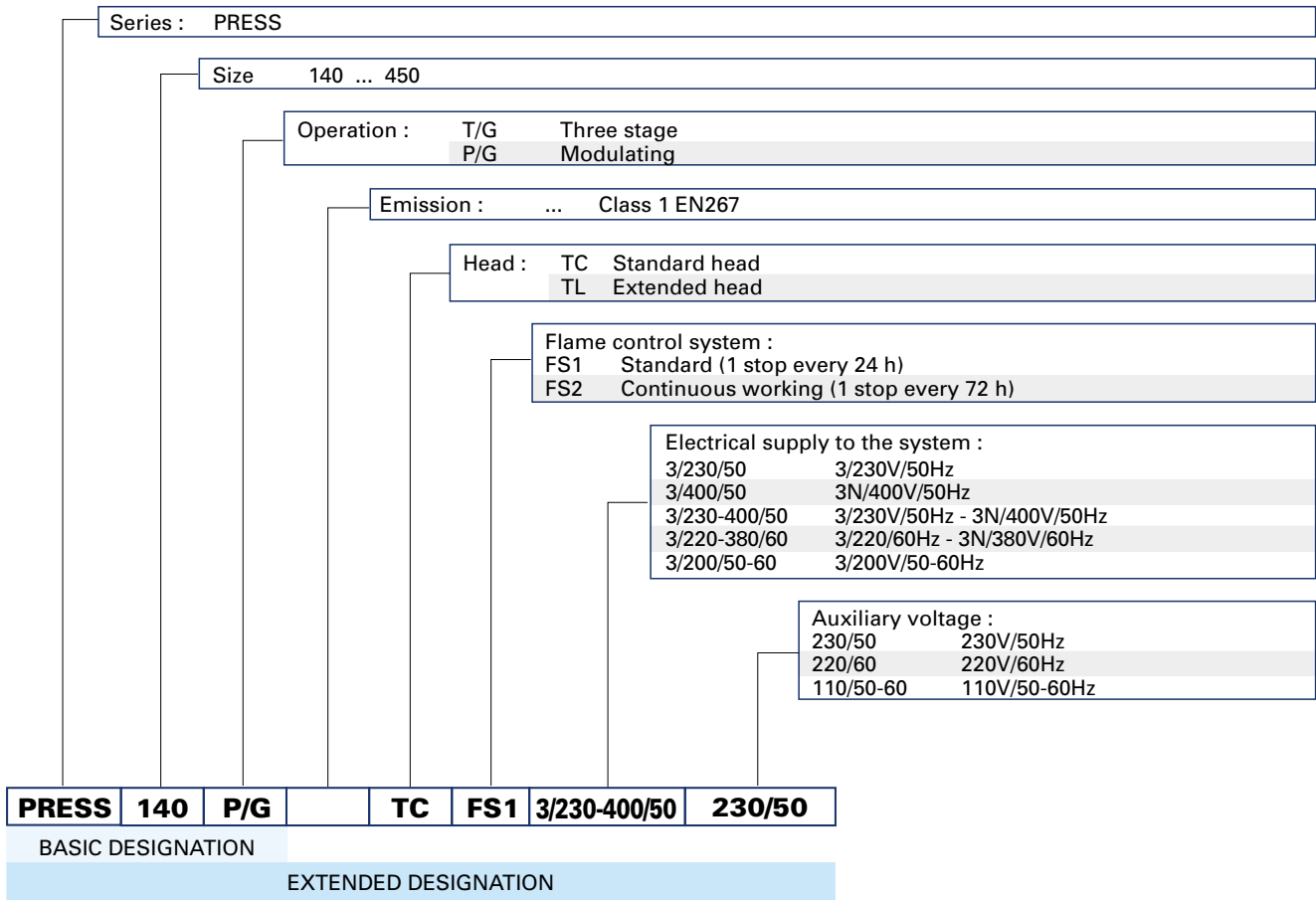

## P/G series - STATE OF SUPPLY

Monoblock forced draught oil burner, two stage progressive or modulating operation, with a kit, fully automatic, made up of:

- Air suction circuit
- Fan with forward curved blades high performance pressure levels
- Air damper for air setting and automatic oil output regulator controlled by a servomotor with variable cam
- Starting motor at 2850rpm, three-phase 400V with neutral, 50Hz
- Combustion head, that can be set on the basis of the required output, fitted with:
  - stainless steel end cone, resistant to corrosion and high temperatures
  - ignition electrodes
  - flame stability disk
- Gears pump for high pressure fuel supply, fitted with:
  - filter
  - pressure regulator
  - connections for installing a pressure gauge and vacuumeter
  - internal by-pass for single pipe installation
- Valve unit with a double oil safety valve on the output circuit and double safety valve on the return circuit
- Safety oil pressure switch for stop the burner in the case of problems on return circuit
- Photocell for flame detection
- Flame control panel, fitted with control function for the correct positioning of the servomotor and possibility of post-ventilation
- Flame inspection window
- Slide bars for easier installation and maintenance
- Protection filter against radio interference
- IP 40 electric protection level.

### Standard equipment:

- 2 flexible pipes for connection to the oil supply network
- 2 nipples for the connection to the pump
- wiring looms fittings for electrical connections
- 4 screws for fixing the burner flange to the boiler
- Instruction handbook for installation, use and maintenance
- Spare parts catalogue
- 2 slide bar extensions (for the extended head models of P 300 P/G e P 450 P/G).

## P/G series - AVAILABLE BURNER MODELS

Code	Model	Heat output		Total electrical power kW	Certification	Note	Price
		kW	kg/h				
3476867	PRESS 140 P/G TC FS1 3/230-400/50 230/50	415/830+1660	35/70+140	4,5	DIN 5G459/2000		
3476868	PRESS 140 P/G TL FS1 3/230-400/50 230/50	415/830+1660	35/70+140	4,5	DIN 5G459/2000		
3477767	PRESS 200 P/G TC FS1 3/230-400/50 230/50	590/1185+2370	50/100+200	5,5	DIN 5G460/2000		
3477768	PRESS 200 P/G TL FS1 3/230-400/50 230/50	590/1185+2370	50/100+200	5,5	DIN 5G460/2000		
3478941	PRESS 300 P/G TC FS1 3/230-400/50 230/50	890/1780+3560	75/150+300	10	DIN 5G461/2000		
3478942	PRESS 300 P/G TL FS1 3/230-400/50 230/50	890/1780+3560	75/150+300	10	DIN 5G461/2000		
3478943	PRESS 300 P/G TC FS1 3/230/50 230/50	890/1780+3560	75/150+300	10	DIN 5G461/2000		
3478944	PRESS 300 P/G TL FS1 3/230/50 230/50	890/1780+3560	75/150+300	10	DIN 5G461/2000		
3478945	PRESS 300 P/G TC FS1 3/400/50 230/50	890/1780+3560	75/150+300	10	DIN 5G461/2000		
3478946	PRESS 300 P/G TL FS1 3/400/50 230/50	890/1780+3560	75/150+300	10	DIN 5G461/2000		
3479369	PRESS 450 P/G TC FS1 3/230/50 230/50	1190/2670+5340	100/225+450	15	DIN 5G462/2000		
3479370	PRESS 450 P/G TL FS1 3/230/50 230/50	1190/2670+5340	100/225+450	15	DIN 5G462/2000		
3479371	PRESS 450 P/G TC FS1 3/400/50 230/50	1190/2670+5340	100/225+450	15	DIN 5G462/2000		
3479372	PRESS 450 P/G TL FS1 3/400/50 230/50	1190/2670+5340	100/225+450	15	DIN 5G462/2000		

Net calorific value: 11,8 kWh/kg; 10200 kcal/kg - Viscosity at 20°C: 4-6 mm<sup>2</sup>/s (cSt).

The burners of PRESS series are in according to 89/336 - 73/23 - 92/42 - 89/392 CEE Directive and EN 267 Norm.

## P/G series - BURNER ACCESSORIES

### Return nozzles type B3 45°

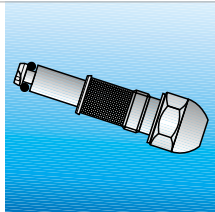

The following list shows the features and codes on the basis of the maximum required fuel output.

NOTE: each burner needs N° 1 nozzle.

Burner	Rated delivery (kg/h)	Nozzle code	Price
P 140 P/G	70	3009713	
P 140 P/G	80	3009715	
P 140 P/G	90	3009717	
P 140 P/G - P 200 P/G	100	3009720	
P 140 P/G - P 200 P/G	125	3009723	
P 200 P/G - P 300 P/G	150	3009726	
P 200 P/G - P 300 P/G	175	3009729	
P 200 P/G - P 300 P/G	200	3009732	
P 300 P/G - P 450 P/G	225	3009735	
P 300 P/G - P 450 P/G	250	3009738	
P 300 P/G - P 450 P/G	275	3009741	
P 300 P/G - P 450 P/G	300	3009744	
P 450 P/G	325	3009747	
P 450 P/G	350	3009750	
P 450 P/G	375	3009753	
P 450 P/G	400	3009756	
P 450 P/G	425	3009759	
P 450 P/G	450	3009762	

### Spacer kit

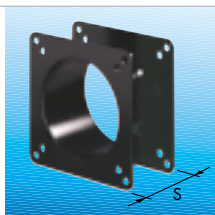

If burner head penetration into the combustion chamber needs reducing, varying thickness spacers are available, as given in the following list:

Burner	Spacer thickness S (mm)	Kit code	Price
P 140 P/G	110	3000722	
P 200 P/G	110	3000722	
P 300 P/G	130	3000723	
P 450 P/G	130	3000751	

### Sound proofing box



If noise emission needs reducing even further, sound-proofing boxes are available.

Burner	Box type	Average noise reduction [dB(A)]	Box code	Price
P 140 P/G - P 200 P/G	C5	15	3000780	
P 300 P/G - P 450 P/G	C6	16	3000781	

## Accessories for modulating operation



To obtain modulating operation, the RL/M series of burners requires a regulator.

Burner	Regulator type	Regulator code	Price
P 140 - 200 - 300 - 450 P/G	RWF 40	3010211	



The relative temperature or pressure probes fitted to the regulator, must be chosen on the basis of the application.

Probe type	Range (°C) (bar)	Probe code	Price
Temperature PT 100	-100 ÷ 500°C	3010110	
Pressure 4 ÷ 20 mA	0 ÷ 2,5 bar	3010213	
Pressure 4 ÷ 20 mA	0 ÷ 16 bar	3010214	

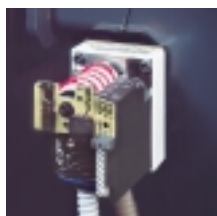

Depending on the servomotor fitted to the burner, a three-pole potentiometer (1000 Ω) can be installed to check the position of the servomotor.

Burner	Potentiometer kit code	Price
P 140 P/G - P 200 P/G - P 300 P/G - P 450 P/G	3010021	

## Burner support

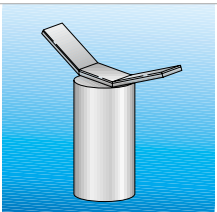

For easier maintenance, a mobile burner support has been designed, which means the burner can be dismantled without the need of forklift trucks.

Burner	Support code	Price
P 300 P/G - P 450 P/G	3000731	